



D/F MACHINE SPECIALTIES, INC.

“MIG” AND “TIG” WELDING TOOLS

1750 Howard Drive, North Mankato, MN 56003

Phone: (507) 625-6200 Fax: (507) 625-6203

Email: sales@dfmachinespecialties.com

www.dfmachinespecialties.com

**REMOTE MOUNT
DOCKING SPOOL®/WELD BODY COMBINATION
accommodates
WATER COOLED NOZZLES**

**WATER COOLED NOZZLE
5" LONG**



**WATER COOLED NOZZLE
HI-CAPACITY
SERIES-A 5"**



**WATER COOLED NOZZLE
LONG REACH**



INSTRUCTIONS and PARTS

CONTENTS

	Page		Page
Introduction	3	Ordering Information	9
Current Tips/Gas Nozzles	4	Complete Assemblies	10
Disassembly/Assembly	5	Standard Assemblies	11
Model NCM - Parts Standard 5"	6	Standard 5" - Layout	12
Model NCM - Parts Series A Hi-Capacity 5"	7	Series A 5" - Layout	13
Model NCM - Parts Long Reach	8	Long Reach - Layout	14
		Wire Feeder Adapters/Inlets	15

SAFETY

Welding is not particularly hazardous when certain safety practices are followed. Anyone using this equipment should be thoroughly trained in safe welding practices. Failure to observe safe practices may cause serious injury.

For more information, refer to the following standards in their latest revisions and comply as applicable.

1. **ANSI Standard Z49.1, SAFETY IN WELDING AND CUTTING** obtainable from the American Welding Society, 2501 N.W. 7th St., Miami, FL 33125.
2. **ANSI Standard Z41.1, STANDARD FOR MEN'S SAFETY - TOE FOOTWEAR** obtainable from the American National Standards Institute, 1430 Broadway, New York, NY 10018.
3. **ANSI Standard Z49.2, FIRE PREVENTION IN THE USE OF CUTTING AND WELDING PROCESSES** obtainable from the American National Standards Institute, 1430 Broadway, New York, NY 10018.
4. **OSHA, SAFETY AND HEALTH STANDARDS, 29CFR 1910**, obtainable from the U.S. Government Printing Office, Washington, D.C. 20402.
5. **AWS Standard A6.0, WELDING AND CUTTING CONTAINERS WHICH HAVE HELD COMBUSTIBLES** obtainable from the American Welding Society, 2501 N.W. 7th St., Miami, FL 33125.
6. **NFPA Standard 70-1978, NATIONAL ELECTRICAL CODE** obtainable from the National Fire Protection Association, 470 Atlantic Avenue, Boston, MA 02210.
7. **ANSI Standard Z88.2, "Practice for Respiratory Protection"** obtainable from the American National Standards Institute, 1430 Broadway, New York, NY 10018.
8. **ANSI Standard Z87.1, SAFE PRACTICES FOR OCCUPATION AND EDUCATIONAL EYE AND FACE PROTECTION** obtainable from the American National Standards Institute, 1430 Broadway, New York, NY, 10018.
9. **NIOSH, SAFETY AND HEALTH IN ARC WELDING AND GAS WELDING AND CUTTING** obtainable from the Superintendent of Documents, U.S. Printing Office, Washington, D.C. 20402.
10. **American Welding Society Standard AWSF4.1 "Recommended Safe Practices for the Preparation for Welding and Cutting of Containers and Piping That Have Held Hazardous Substances"**, obtainable from the American Welding Society, 2501 N.W. 7th St., Miami, FL 33125.

INTRODUCTION

This manual covers Remote Mount Water Cooled Nozzles which offer a concept with interchangeability of Models for Mechanized "MIG" Welding. The Water Cooled Nozzles accommodate a wire diameter range of .030" - 1/16" hard wires, .035" - 7/64" tubular wires, and 3/64" - 3/32" soft wires.

The equipment consists of four (4) basic components: a utility station, an intermediate utilities combination assembly, a Remote Mount Docking Spool body, and a Water Cooled Nozzle. The Remote Mount Docking Spool body is the principal component in this welding equipment arrangement. It accepts the utilities at the top end of the spool and provides a means of accepting the nozzle assembly at the lower end. In addition, several other features important to a welding system are provided. Incorporated within the water chamber of the Docking Spool body are check valves which provide a means of retaining the residual water in the lines when the nozzle is removed from the Docking Spool body. Also, a Posit ring is provided to allow positive location at the mounting bracket to achieve dimensional stability.

These welding assemblies are designated by Models. Three (3) are illustrated in the parts breakdown lists. The Model NCM covered herein has a current capacity of 450/600 amperes in argon shielding. These accommodate slip-in current tips fastened by a collet action nut. This arrangement increases the versatility of the equipment by allowing tip extension beyond the gas nozzle where critical access problems to the weld area are encountered. The wire diameter with hard wire is .030" - 1/16", cored wire .035" - 7/64", and aluminum wire diameter range of 3/64" - 3/32".

Page 9 lists the complete equipment assemblies.

On page 10 and 11 the standard arrangement with a utility station is shown.

IMPORTANT

Make certain the cooling water supply is at least the flow rate of 5 pints per minute at 50 psi (80 psi maximum). Gun ratings are affected by shielding gas used, arc time, cooling time, and inlet water temperature. Water outlet temperatures should not exceed 120° F.

To obtain maximum performance with this water cooled equipment a water circulator of the heat exchanger type with a heat displacement of 30,000 BTUs at 72° F should be used.

CURRENT TIPS – TABLE I



CURRENT TIPS – 1/4" DIAMETER SLIP-IN

	WIRE SIZE	WIRE TYPE	CODE NO.
(Bent)	.030"	Hard	10787
	.035"	Hard	10788
	.045"	Hard	10789
	.052"	Hard	10830
	1/16"	Hard	10790
	3/64"	Aluminum	10781
	1/16"	Aluminum	10782
	3/32"	Aluminum	10783
	3/64"	Aluminum	15176
	1/16"	Aluminum	15177

CURRENT TIPS – 5/16" DIAMETER SLIP-IN

	WIRE SIZE	WIRE TYPE	CODE NO.
(Tip provides 1/8" set back)	.030"	Hard	10883
	.035"	Hard	10884
	.045"	Hard	10885
	.052"	Hard	10886
	1/16"	Hard	10887
	5/64"	Hard	10888
	3/32"	Hard	10889
(Tip provides 3/8" set back)	.035"	Cored	10893
	.045"	Cored	10894
	.052"	Cored	10895
	1/16"	Cored	10896
	5/64"	Cored	10897
	3/32"	Cored	10898
	7/64"	Cored	10899
(Tip provides 1/8" set back)	3/64"	Soft	10902
	1/16"	Soft	10903
	3/32"	Soft	10904



GAS NOZZLE – TABLE II

REF.	CODE NO.	TYPE	O.D.	I.D.
1	10362	Copper Tapered	15/16"	5/8"
2	10340	Copper Straight	1"	3/4"
3	10359	Copper Tapered	15/16"	5/8"
4	10374	Copper Straight	5/8"	7/16"

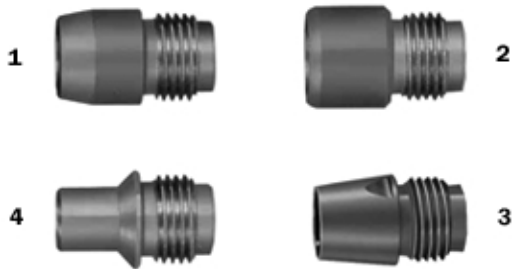

GAS NOZZLE – TABLE III – Water Cooled Nozzles - Series A

REF.	CODE NO.	TYPE	O.D.	I.D.
1	16749	Copper Short Taper	1 3/8"	11/16"
	16750	Copper Short Taper	1 3/8"	13/16"
	16751	Copper Short Taper	1 3/8"	15/16"
2	18030	Copper Full Taper	1 3/8"	11/16"
	18031	Copper Full Taper	1 3/8"	13/16"
	18032	Copper Full Taper	1 3/8"	15/16"



DISASSEMBLY

To remove the Water Cooled Nozzle from the DOCKING SPOOL/Weld Body Combination, proceed as follows:

1. Remove the forward gas nozzle (when used).
2. Unscrew the collet nut with wrench supplied. Wrench is also used to remove 7/16" threaded tips. This will allow removal of the tip and support tube/spatter disc arrangement.
3. Unscrew the fastening nut which applies the water cooled nozzle assembly to the DOCKING SPOOL/Weld Body Combination. The water cooled nozzle may now be pulled from the DOCKING SPOOL/Weld Body Combination.
4. The water transfer fittings may be removed from the water cooled nozzle with a 7/16" open end wrench. Following this the insulating collar may be removed.
5. If the tip adapter in the DOCKING SPOOL/Weld Body Combination should be worn or damaged proceed as follows:
Two 1/2" open end wrenches are needed to remove the adapter/jam nut assembly from the DOCKING SPOOL/Weld Body Combination. Break jam nut loose first, and then remove assembly.

ASSEMBLY

1. Apply proper tip adapter to DOCKING SPOOL/Weld Body Combination.
 - a. Fully tighten adapter until securely seated.
 - b. Using two 1/2" open end wrenches, firmly tighten jam nut to lock adapter to assembly.
2. The nylon collar should be placed over the fittings on the rear of the water cooled nozzle assembly. It is important that the collar alignment indication hole (viewed from the rear of the nozzle) align with the small concave mark provided on the collar of the water cooled nozzle. Apply the water transfer fittings to the fittings provided on the water cooled nozzle.
3. The nozzle assembly may now be applied to the DOCKING SPOOL/Weld Body Combination. For proper orientation of the water fittings to the channels provided in the DOCKING SPOOL/Weld Body Combination it is extremely important that the indicator hole in the collar align with the small concave mark provided on the face of the DOCKING SPOOL. This alignment will allow the water cooled nozzle to be pushed up into the DOCKING SPOOL after which the nut may be applied.
4. The insulation tube should now be placed in the water cooled nozzle. This should be followed by applying the spatter disc. When spatter disc (10405) is replaced make certain that the counterbored end is facing the Weld Body. Replacement of spatter disc/support tube is accomplished by sliding the spatter disc (18253) into the water cooled nozzle, followed by pushing the support tube up into the water cooled nozzle. Apply the current tip and replace gas nozzle.

SPARE PARTS

It is recommended that the spare parts in Table 1 be on hand to assure minimum downtime.

ITEM	CODE NO.	MIN. QUANTITY
Adapter Assembly	To Be Selected	1
Body Liner	To Be Selected	2
Insulation Tube	To Be Selected	1
Water Cooled Nozzle	To Be Selected	1
Spatter Disc	To Be Selected	2
Current Tip	To Be Selected	5
Gas Nozzle	To Be Selected	2

**REMOTE MOUNT
DOCKING SPOOL® / WELD BODY COMBINATION
MODEL-NCM (SLIP-IN TIP)
WATER COOLED NOZZLE
LONG 5"**

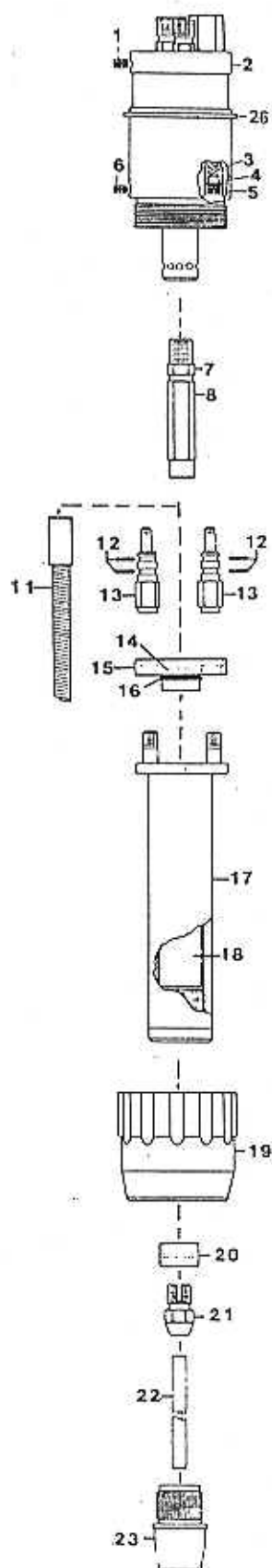

REF.	CODE NO.	DESCRIPTION
1	14715	Socket Set Screw.
2	45157	DOCKING SPOOL/Weld Body Combination
3	40022	Spring
4	40023	Ball
5	40024	Seat
6	13883	Socket Set Screw
7	11860	Jam Nut
8	12023	Adapter Assembly-1/4" Slip-In Tip
	18313	Adapter Assembly-5/16" Slip-In Tip
9		
10		
11	45880	Body Liner .030"-.035"
	45881	Body Liner .035"-.045"
	45882	Body Liner .045"-1/16"
	45892	Body Liner 5/64"-3/32"
	45893	Body Liner 7/64"-1/8"
	45883	Body Liner 3/64"AL
	45884	Body Liner 1/16"AL
	45885	Body Liner 3/32"AL
12	13921	'O' Rings (4 req'd)
13	40025	Transfer Fitting
14	13912	Internal "O" Ring
15	40010	Insulating Collar
16	12516	External "O" Ring
17	45103	Water Cooled Nozzle-Long 5"
18	12303	Insulation Tube
19	40001	Nut
20	10405	Spatter Disc
21	11950	Collet Nut-For 1/4" Slip-In Tip
	18262	Collet Nut-For 5/16" Slip-In Tip
22		Current Tips-see table IV
23		Gas Nozzles-see table II
24	12111	Wrench
25	14610	Nozzle Thread Chaser Tap
26	40026	POSIT Ring

**REMOTE MOUNT
DOCKING SPOOL® / WELD BODY COMBINATION
MODEL-NCM (SLIP-IN TIP)
WATER COOLED NOZZLE
HI-CAPACITY SERIES-A 5"**

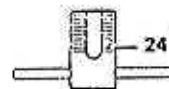
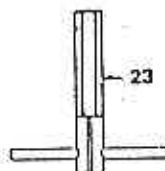
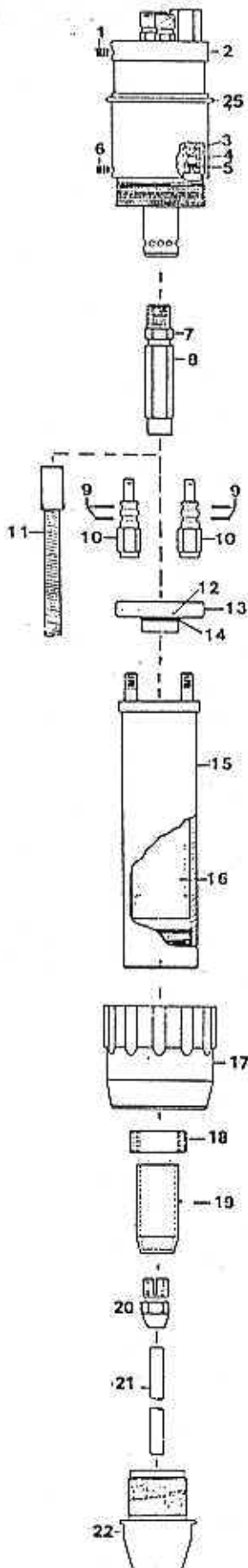

REF.	CODE NO.	DESCRIPTION
1	14715	Socket Set Screw.
2	45157	DOCKING SPOOL/Weld Body Combination
3	40022	Spring
4	40023	Ball
5	40024	Seat
6	13883	Socket Set Screw
7	11860	Jam Nut
8	12023	Adapter Assembly-1/4" Slip-In Tip
	18313	Adapter Assembly-5/16" Slip-In Tip
9	13921	"O" Rings (4 req'd)
10	40025	Transfer Fitting
11	45880	Body Liner .030"-.035"
	45881	Body Liner .035"-.045"
	45882	Body Liner .045"-1/16"
	45892	Body Liner 5/64"-3/32"
	45893	Body Liner 7/64"-1/8"
	45883	Body Liner 3/64"AL
	45884	Body Liner 1/16"AL
	45885	Body Liner 3/32"AL
12	13912	Internal "O" Ring
13	40010	Insulating Collar
14	12516	External "O" Ring
15	45127	Water Cooled Nozzle Series-A 5" Noz.
16	18383	Insulation Tube
17	40003	Nut
18	18253	Splatter Disc
19	18252	Support Tube
20	11950	Collet Nut-For 1/4" Slip-In Tip
	18262	Collet Nut-For 5/16" Slip-In Tip
21		Current Tips-see table IV
22		Gas Nozzles-see table III
23	12111	Wrench
24	14614	Nozzle Thread Chaser Tap
25	40026	POSIT Ring

**REMOTE MOUNT
DOCKING SPOOL® / WELD BODY COMBINATION
MODEL-NCM (SLIP-IN TIP)
WATER COOLED NOZZLE
LONG REACH**

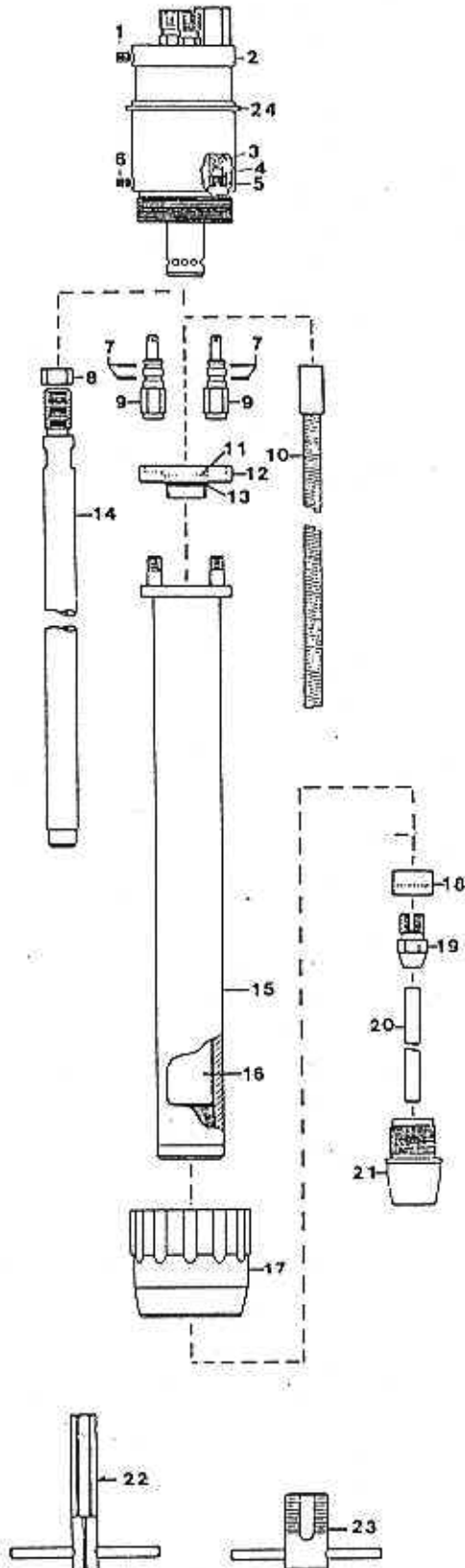

Ref.	Code No.	Description
1	14715	Socket Set Screw.
2	45157	DOCKING SPOOL/Weld Body Combination
3	40022	Spring
4	40023	Ball
5	40024	Seat
6	13883	Socket Set Screw
7	13921	"O" Rings (4 req'd)
8	11960	Jam Nut
9	40025	Transfer Fitting
10	45900	Body Liner .030"-.035" H/C
	45901	Body Liner .035"-.045" H/C
	45902	Body Liner .045"-1/16" H/C
	45909	Body Liner .5/64"-1/8" C
	45903	Body Liner 3/64" AL
	45904	Body Liner 1/16" AL
	45905	Body Liner 3/32" AL
11	13912	Internal "O" Ring
12	40010	Insulating Collar
13	12516	External "O" Ring
14	18241	Adapter .030"-1/16" For 1/4" Slip-In Tip
		Adapter 3/64"-3/32" AL For 1/4" Slip-In Tip
	18367	Adapter .030"-7/64" For 5/16" Slip-In Tip
15	45107	Water Cooled Nozzle-Strd Long Reach
16	18108	Insulation Tube
17	40001	Nut
18	10405	Spatter Disc
19	11950	Collet Nut-For 1/4" Slip-In Tip
	18262	Collet Nut-For 5/16" Slip-In Tip
20		Current Tip-See Table IV
21		Gas Nozzle-See Table II
22	12111	WRENCH
23	14610	Nozzle Thread Chaser Tap
24	40026	POSIT Ring

ORDERING INFORMATION: COMPLETE ASSEMBLIES

Advise Wire Diameter and Feeder Manufacturer

	Complete Assembly- Consists of Water Cooled Nozzle, DOCKING SPOOL, and Utility Combination
WATER COOLED NOZZLES	MODEL-NCM
WATER COOLED NOZZLE SERIES-A 5" HI-CAPACITY	40753-11-6 11 FT. UTILITIES 6 FT. CASING
	40754-11-7 11 FT. UTILITIES 7 FT. CASING
WATER COOLED NOZZLE LONG - 5" STRD.	40755-11-6 11 FT. UTILITIES 6 FT. CASING
	40756-11-7 11 FT. UTILITIES 7 FT. CASING
WATER COOLED NOZZLE LONG REACH	40201-11-6 11 FT. UTILITIES 6 FT. CASING
	40202-11-7 11 FT. UTILITIES 7 FT. CASING

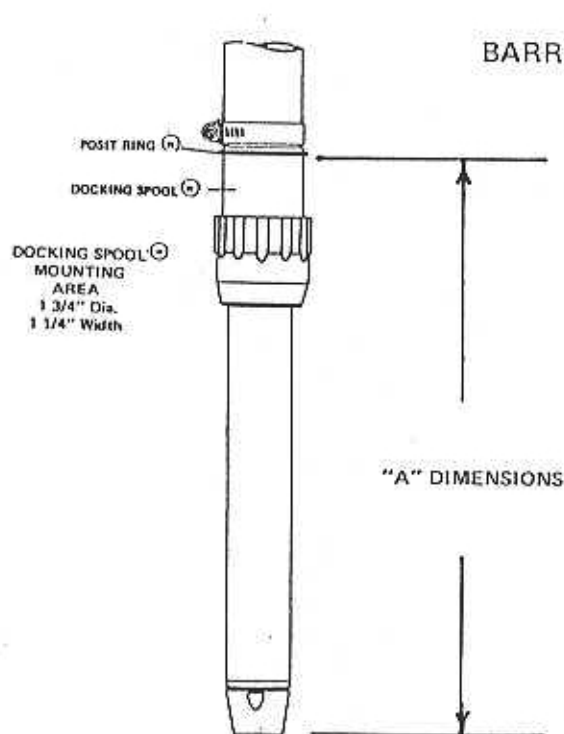

BARREL DIMENSIONS

"A" DIMENSIONS		
Long - 5"		8.125"
Series-A 5"		8.125"
L.R. Standard	9-25/32"	12.093"

REMOTE MOUNT DOCKING SPOOL® / WELD BODY COMBINATION WATER COOLED NOZZLE ASSEMBLIES

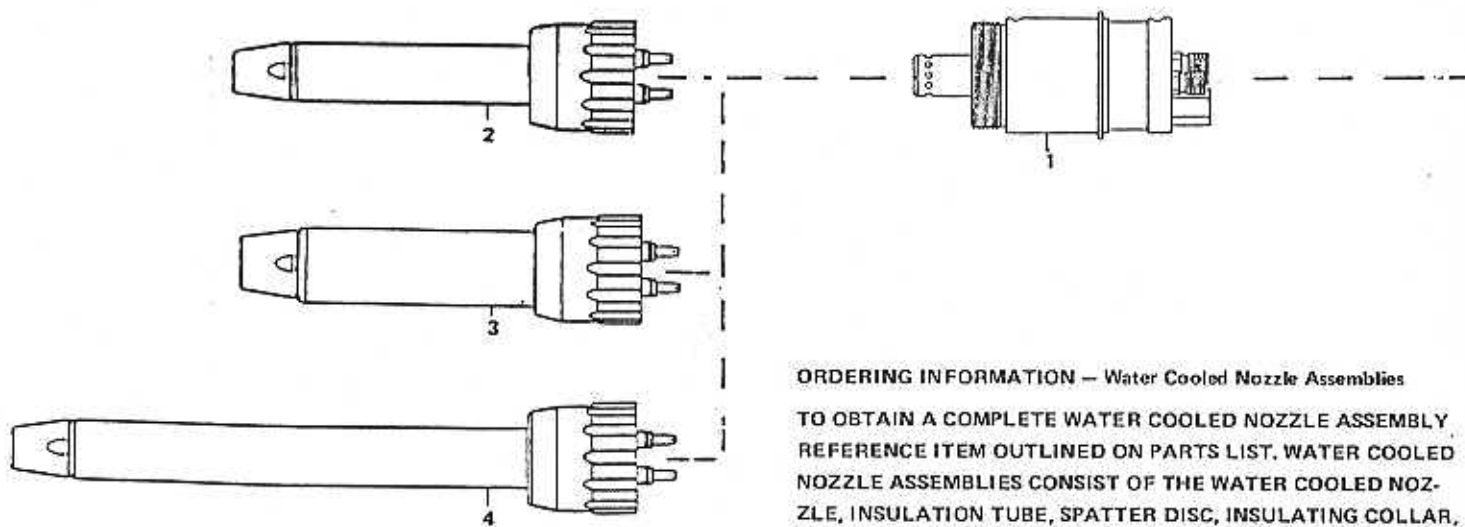

ORDERING INFORMATION — Water Cooled Nozzle Assemblies

TO OBTAIN A COMPLETE WATER COOLED NOZZLE ASSEMBLY, REFERENCE ITEM OUTLINED ON PARTS LIST. WATER COOLED NOZZLE ASSEMBLIES CONSIST OF THE WATER COOLED NOZZLE, INSULATION TUBE, SPATTER DISC, INSULATING COLLAR, WATER TRANSFER FITTINGS, WELD BODY ADAPTER AND NUT.

NOTE: SPECIFY WIRE DIAMETER, GAS NOZZLE AND CURRENT TIP (Page 2).

REF.	CODE NO.	DESCRIPTION
1	45157	DOCKING SPOOL/Weld Body Combination
2	48202	W/C Nozzle Assembly 5"
3	48264	W/C Nozzle Assembly Series-A 5"
4	48220	W/C Nozzle Assembly Long Reach

STANDARD ASSEMBLIES

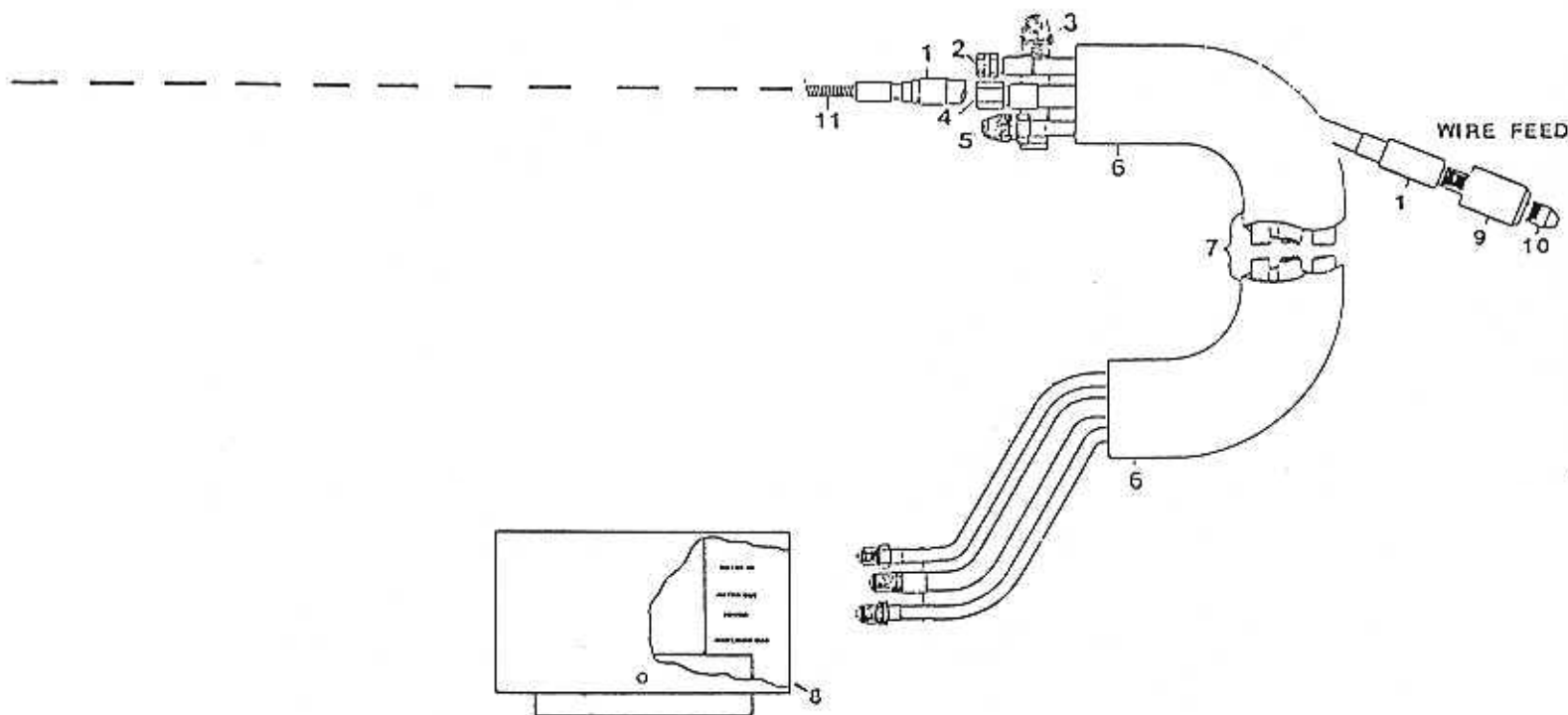

REF.	CODE NO.	DESCRIPTION	REF.	CODE NO.	DESCRIPTION
1	46350	CASING .030"-.035" (REQUIRES Liner)	7	46624-11-6	5/64"-3/32"(Single Piece Casing)
	46370	CASING .035"-1/16"(REQUIRES Liner)		46624-11-7	5/64"-3/32"(Single Piece Casing)
	46420	CASING .035"-.045" SINGLE PIECE		46625-11-6	7/64"-1/8"(Single Piece Casing)
	46440	CASING .045"-1/16" SINGLE PIECE		46625-11-7	7/64"-1/8"(Single Piece Casing)
	46460	CASING 5/64"-3/32" SINGLE PIECE	8	45196	UTILITY STATION
	46480	CASING 7/64"-1/8" SINGLE PIECE	9		FEEDER ADAPTER
2	46300	WATER IN HOSE ASSEMBLY	10		INLET
3	14803	CLAMP	11	47020	LINER .030"-.035" HARD/CORED
4	46320	WATER OUT HOSE & POWER CABLE ASSY.		47021	LINER .035"-.045" HARD/CORED
5	46260	GAS HOSE ASSEMBLY		47022	LINER .045"-1/16" HARD/CORED
6	46630	CABLE/HOSE SHEATH		47023	LINER 3/64" SOFT
7		UTILITY COMBINATION-CONSISTING OF ITEMS 1,2,3,4,5,6 & 11		47024	LINER 1/16" SOFT
	46620-11-6	.030"-.035"(With 46350-6 Casing)		47025	LINER 3/32" SOFT
	46620-11-7	.030"-.035"(With 46350-7 Casing)			
	46621-11-6	.035"-1/16"(With 46370-6 Casing)			
	46621-11-7	.035"-1/16"(With 46370-7 Casing)			
	46622-11-6	.035"-.045"(Single Piece Casing)			
	46622-11-7	.035"-.045"(Single Piece Casing)			
	46623-11-6	.045"-1/16"(Single Piece Casing)			
	46623-11-7	.045"-1/16"(Single Piece Casing)			

ORDERING INFORMATION: Add footage digit to code number to obtain single items such as hoses, casings, liners or sheaths. Utility combinations are obtained by Code No. as listed

ROBOTIC MACHINE BARREL LAYOUT

REMOTE MOUNT
DOCKING SPOOL® / WELD BODY COMBINATION
MODEL NCM (SLIP-IN TIP)
W/C NOZZLE 5"

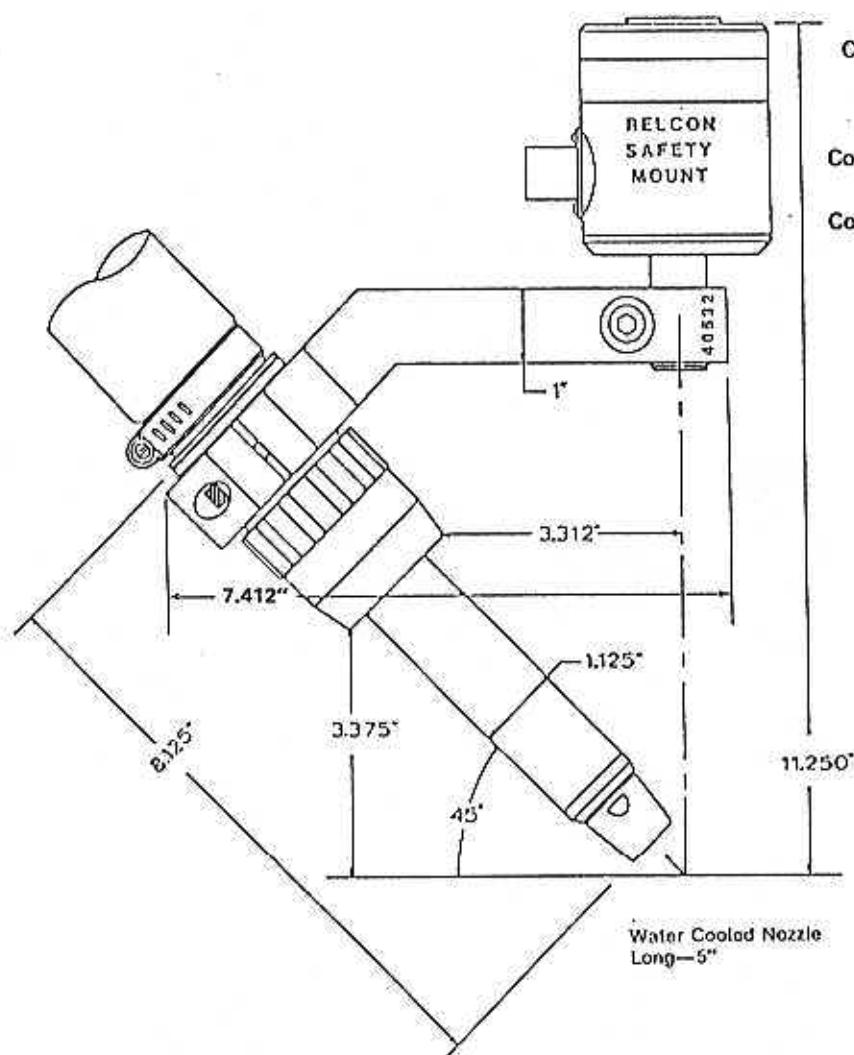

Code No. 40547 Mounting Disc (GMF)

Code No. 40519 Med. Duty Mount

Code No. 40520 Heavy Duty Mount

ROBOTIC MACHINE BARREL LAYOUT

REMOTE MOUNT
DOCKING SPOOL[®] / WELD BODY COMBINATION
MODEL NCM (SLIP-IN TIP)
W/C NOZZLE SERIES-A 5"

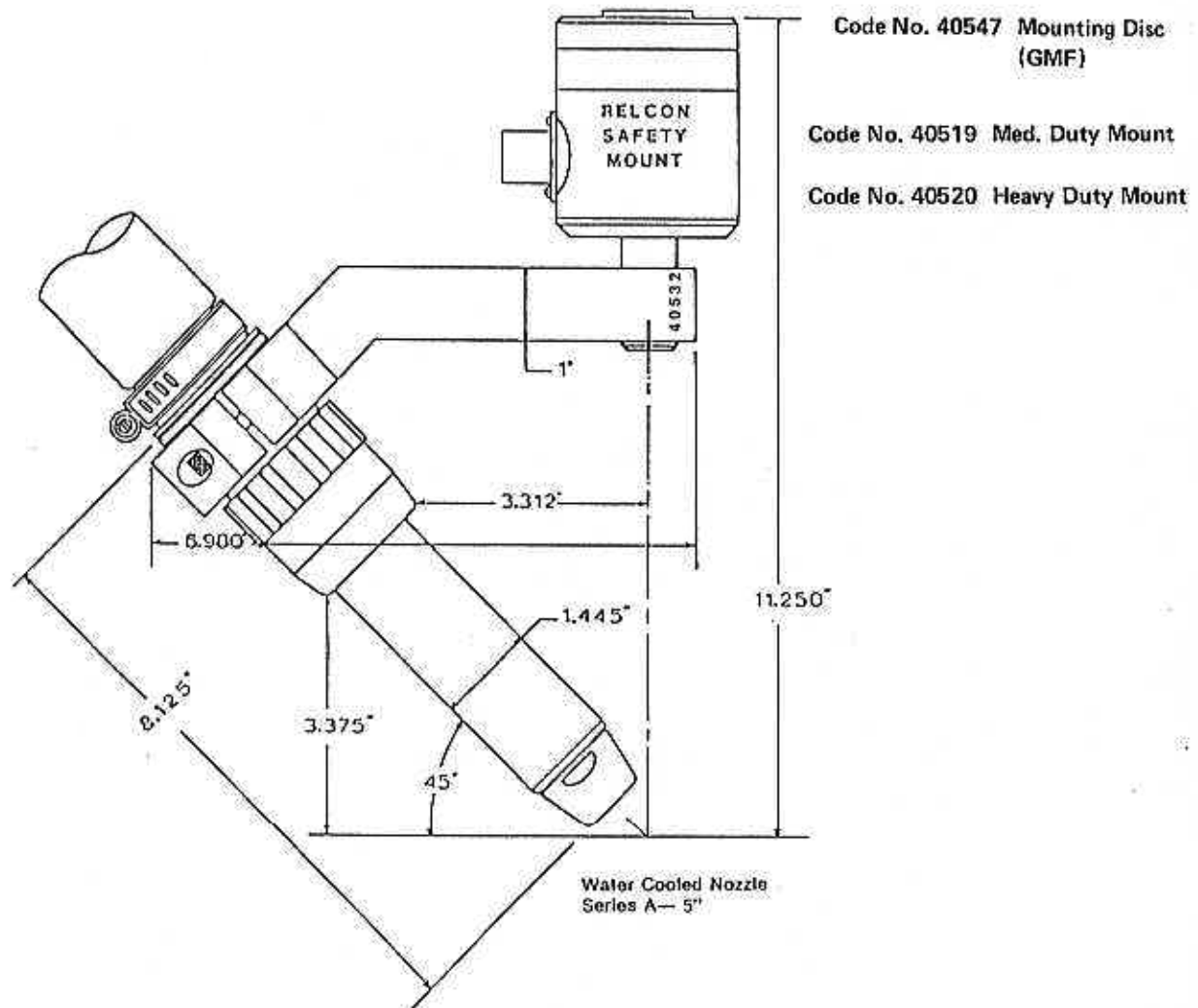

ROBOTIC MACHINE BARREL LAYOUT

REMOTE MOUNT
DOCKING SPOOL®/ WELD BODY COMBINATION
MODEL NCM (SLIP-IN TIP)
LONG REACH NOZZLE

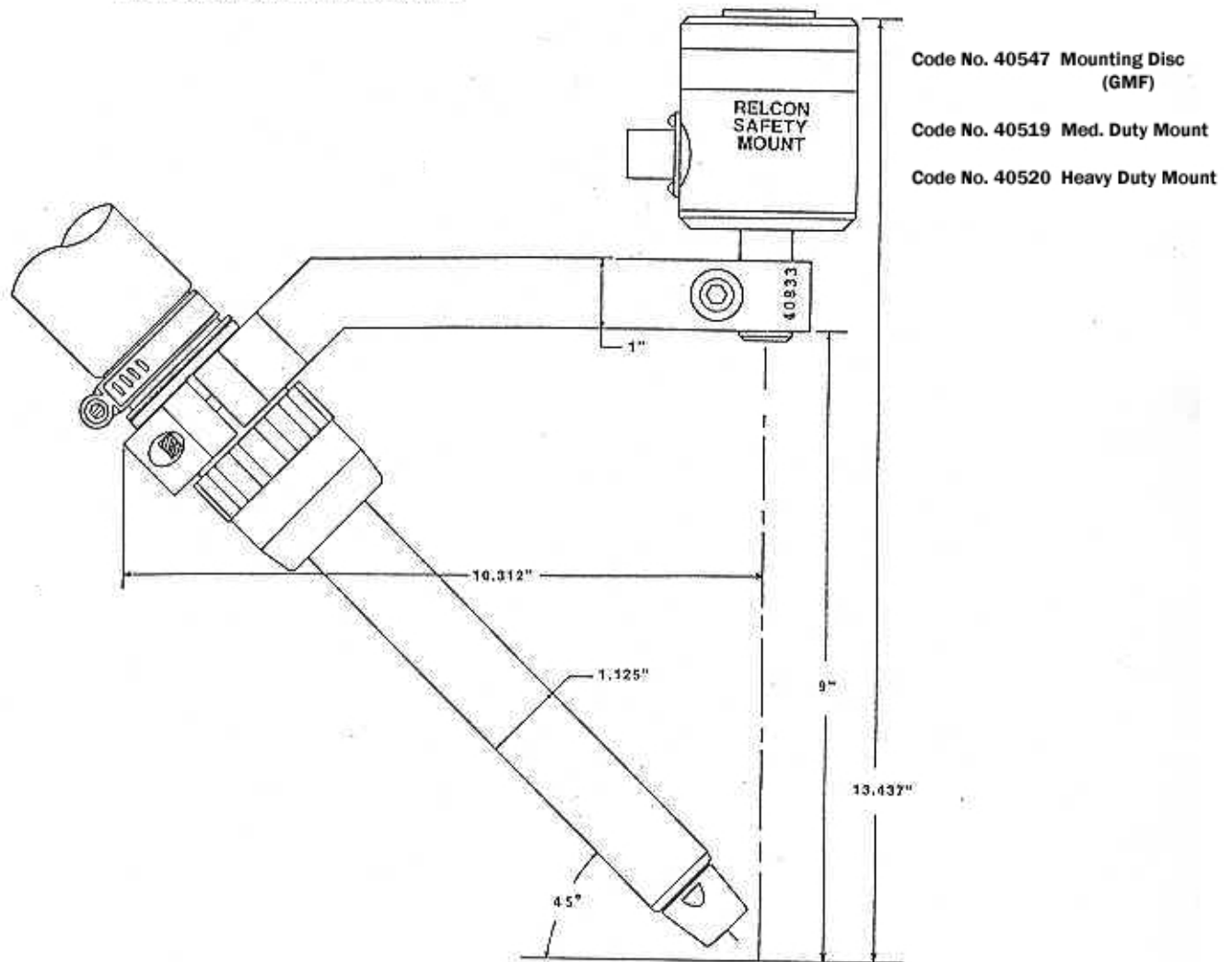



WIRE FEEDER ADAPTERS AND WIRE INLETS

Manu- facturer	Models	Wire Diameter	Remote Adapter			Direct Mount Adapter	
			Hard or Al	Cored	*Stub Liner	Hard or Al	Cored
Airco	AHF-T	.030"-.035" Hard	13031		16166	13032	
	AHF-N	.045"-1/16" Hard	13031		16167	13032	
	AHF-R1	3/64" Soft	13031		16654	13032	
	AFH-U1	1/16" Soft	13031		16655	13032	
	AHF-V1	3/32" Soft	13031		16656	13032	
	AHF-V6	5/64"-3/32" Cored		13029	16168		13028
	AHF-NP AHF-N6	7/64" Cored		13029	16169		13028
Airco	System I/II	Shaft & Spool Assy. Code No. 18209 (Requires Q.D. Socket & Plug— 12981 Assy. & Wire Guide)					
	Wire Guide	.030"-.035" .035"-.045" 3/64" AL 1/16" AL			18238 18210 18212 18213		
Compak- O-Matic	480, 120, 125	.035"-.045" Hard .045"-1/16" Hard 3/64" Soft 1/16" Soft 3/32" Soft 5/64"-3/32" Cored 7/64" Cored	13486 13486 13486 13486 13486 16612 16612	16690 16691 16694 16695 16696 16692 16693	13485 13485 13485 13485 13485 16611 16611		
	No. 75	.035" Hard .045" Hard 1/16" Hard 3/64"-1/16" 3/32" Al 5/64"-3/32" Cored 7/64" Cored	13482 13488 13489 13490 13491 13492		13487 13488 13489 13490 13491 13492		
Esab			18246	18247		18248	18249
Hobart	All Models	.030"-.035" Hard .035"-.045" Hard .045"-1/16" Hard 3/64" Soft 1/16" Soft 3/32" Soft (5/64"-7/64") Cored	13067 13067 13067 13067 13067 13067 16087	16665 16666 16667 16670 16671 16672 16668	13068 13068 13068 13068 13068 13068 16225		
Lincoln	LN-7 LN-8 NA5-R	.035"-.045" Hard .045"-1/16" Hard 3/64" thru 3/32" Al 5/64"-3/32" Cored 7/64" Cored	13110 13110 13111 13112 13112	16698 16699 16700 16701	13110 13110 13111 13112 13112		
Water Cooled Guns	LN-9	.035"-.045" Hard .045"-1/16" Hard 5/64"-3/32" Cored 7/64" Cored	16581 16581 16582 16582	16711 16712 16713 16714	16528 16528 16529 16529		
Power - Feed 10	NA3 NA5	.035"-.045" .045"-1/16" 5/64"-7/64"	13113 13113 16879	16882 16883 16885	16880 16880 16881		

Manu- facturer	Models	Wire Diameter	Remote Adapter			Direct Mount Adapter	
			Hard or Al	Cored	*Stub Liner	Hard or Al	Cored
Linde	SWM31 SWM34 SWM37 SWM38 EH8	Casing to Feeder (Accepts Linde Outlet Guide) D/F Insert .035"-.045" Hard .045"-1/16" Hard 5/64"-3/32" Cored 3/64"-1/16" Al	13046			13046	
Linde	SWM11 SWM113 SWM23 SWM25 EH35 EH10	.035"-.045" Hard .045"-1/16" Hard 3/64" Soft 1/16" Soft 3/32" Soft 5/64"-3/32" Cored 7/64" Cored	13043 13043 13043 13043 13043 13052 13052		16690 16691 16694 16695 16696 16692 16693	13080 13080 13080 13080 13080 13079 13079	
Miller ("50" Series)	S-52A S-52E S-54E S-52D S-54D D-52D	.030"-.035" Hard .035"-.045" Hard .045"-1/16" Hard 3/64" Soft 1/16" Soft 3/32" Soft 5/64"-3/32" Cored 7/64" Cored	16557 16557 16557 16557 16557 16557 16559 16559		16673 16674 16675 16679 16880 16681 16676 16677	16558 16558 16558 16558 16558 16558 16560 16560	
OTC	Requires Insert	.030"-.035" .035"-.045" .045"-1/16" 5/64"-7/64"	18268			18270 18271 18273 18274	18275
Panasonic	PME-12X YW50AKW1	0.30" - 1/16" 0.30" - 1/16"	13090 13466	Requires Inlet			

*Stub liners only required in feeder adapter when single piece casing is used.

FEEDER ADAPTER INLETS

Wire Size	Steel Code No.	Brass Code No.	Nylon Code No.
.030"	13801	16417	
.035"	13803	16418	
.045"	13806	16419	
.052"	13844	16420	
1/16"	13809	16421	
5/64"	13812	16422	
3/32"	13814	16422	
7/64"	13816		
1/8"	13842		
3/64" Al.			13807
1/16" Al.			13810
3/32" Al.			13815

PANASONIC INLETS

Wire Size	Steel Code No.	Brass Code No.	Nylon Code No.
.030"	19609	19600	
.035"	19610	19601	
.045"	19611	19602	
.052"	19612	19603	
1/16"	19613	19604	
5/64"	19614	19605	
3/32"	19615	19606	
7/64"	19616		
1/8"	19617		
3/64" Al.			13807
1/16" Al.			13810
3/32" Al.			13815

WARRANTY

This Equipment is sold by D/F Machine Specialties, Incorporated, under the warranty set forth in the following paragraph. Such warranty is extended only to the buyer who purchases the equipment directly from D/F or its authorized distributor as new merchandise.

The barrel and cable assemblies are warranted by D/F to be free from manufacturing defects for 90 days after delivery by D/F, provided that the equipment is properly operated under conditions of normal use and that regular periodic maintenance and service is performed. Expendable parts are not warranted for any specific time. Expendable parts referred to herein would be the nozzles, current tips, spatter discs, insulators, casing liners, and wire inlets. D/F's sole obligation under this warranty is limited to making replacement at its manufacturing facility for barrel assemblies which are returned to it with transportation charges prepaid, and upon D/F's examination have been found to be so defective.



D/F MACHINE SPECIALTIES, INC.

"MIG" AND "TIG" WELDING TOOLS

1750 Howard Drive, North Mankato, MN 56003

Phone: (507) 625-6200 Fax: (507) 625-6203

Email: sales@dfmachinespecialties.com

www.dfmachinespecialties.com